



GD24 ■ LCD Multipurpose Mount 14"-26"



Features

- 1 UNIVERSAL INSTALLATION
- 2 UNIVERSAL
standard VESA 75x75, 100x100
- 3 MINIMUM DISTANCE
only 91 mm



Technical Data

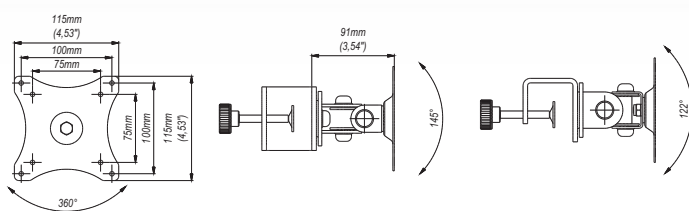

75x75 mm 100x100 mm	14"-26"	91 mm	min. 75x75 mm max. 100x100 mm
10 Kg	122°	145°	
360°			

Trade Information

Index	Colour	Package	EAN
GD24c-B	■	■	5908252961214
GD24s-B	■	■	5908252961221
Package Dimensions [mm] (H x W x D)		200x140x140	
Weight [Kg]		1,1	

Accessories

Series GDA

